

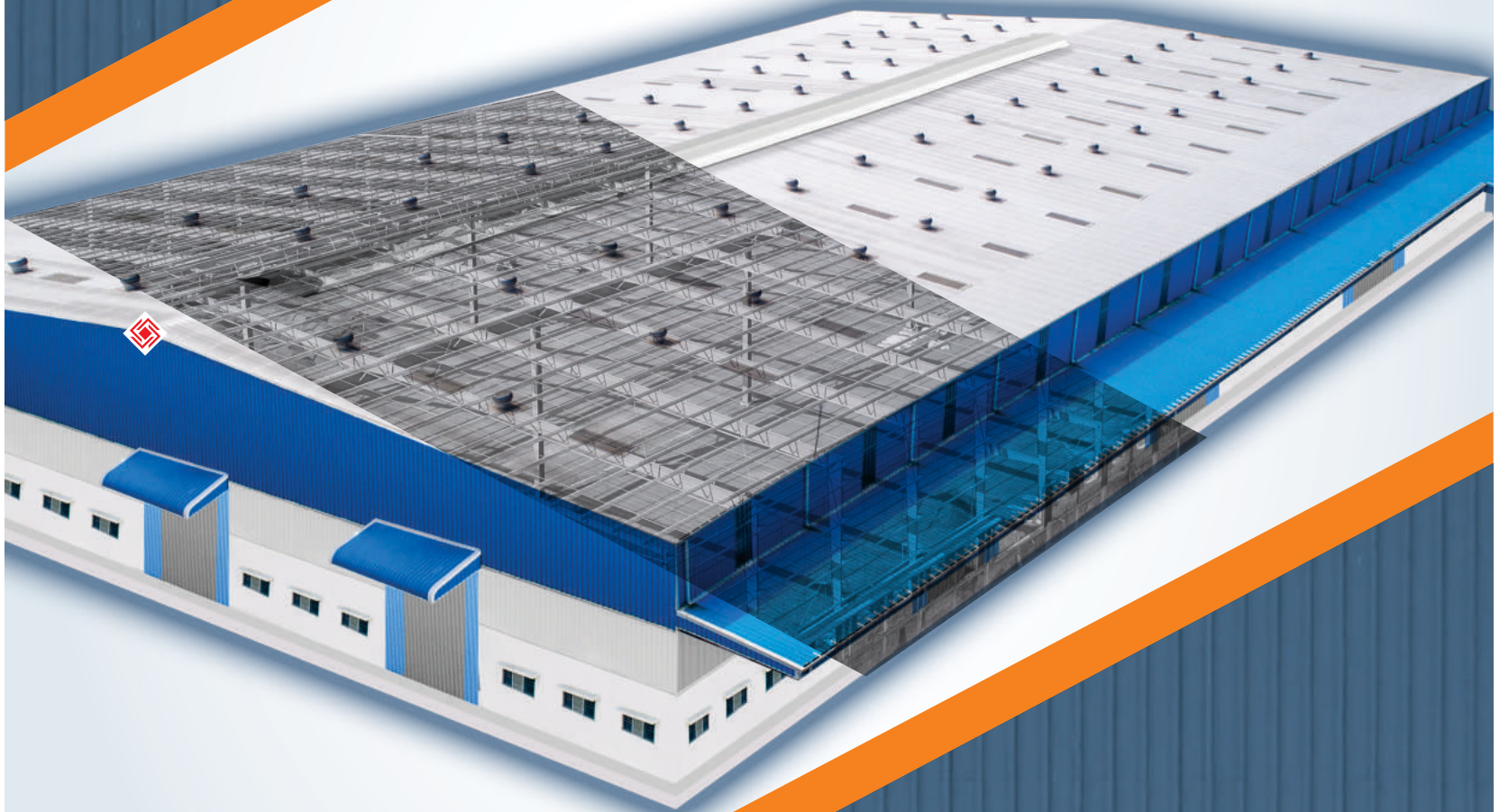

"Your Dream, Our Determination"

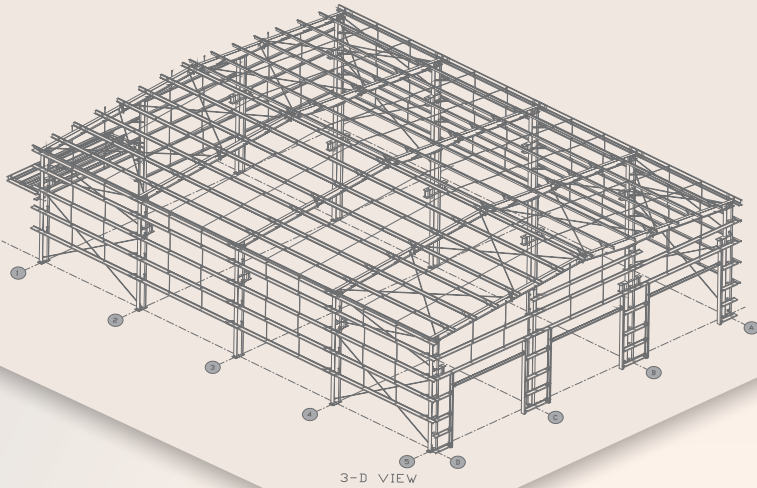

"Pre-Engineered Steel buildings & Structures"



"Your Dream, Our Determination"

### **About us**

With passage of time , Pre engineered building technology in India has been evolving. The use of Best -in-class materials of construction, trendy techniques of assembly and fastening, Value additions to enhance functionality, aesthetics and safety, ruggedness to withstand the weather uncertainties , quality and durability of structure-everything counts when you engineer the modern manufacturing facilities.

Swastik metcon projects are synonymous with sophisticated industrial buildings and warehouses.

Swastik Metcon projects is a partnership firm started by Mr. Kapil Khole and Mr. Lokesh Yeolekar having experience of more than 15 years and delivering more than 1000 + successful projects together.

Mr. Kapil Khole is Mechanical engineer with Masters in operation and takes care of the entire execution of the project. Mr. Lokesh Yeolekar is Instrumentation engineer with Master in Marketing and takes care of client requirements not only from start to successful completion but also ensuring prompt after sales services.

In line with company tag line " Your dream, Our determination " both the partners are determined to achieve client dream and create a model workspace.

### **Vision**

To be India's most reliable and innovative manufacturer service & solution provider in the pre-engineered building industry

### **Mission**

Swastik Metcon projects will consistently be the preferred partner for steel building users, consultants, Architects and contractors.

We give value for money by prompt delivery of high standard quality buildings, supported by accurate engineering design and erection methodology thus providing excellent services to our clients.

### **Policy Statement**

We, Swastik metcon projects are committed to the success of our business , the design, production & supply of pre-engineered/structural steel building and sheeting system.



## Completed Projects



Mulchand Phulchand Krishi Udyog, Jalna



Najeeb-Ul-Haq, Waluj, Aurangabad



SHK Coal Shed, Omerga



Leela Udyog, Jalna



Thakurji Solvent, Jalna



Powerlite, Newasa MIDC

# Frame Type

### Tapered Column Clear Span (TCCS)

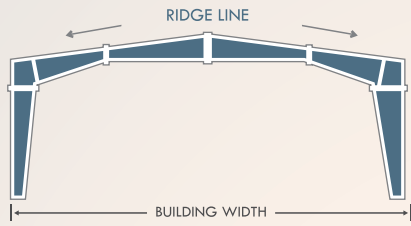

### Multi Gable (MG) I / II

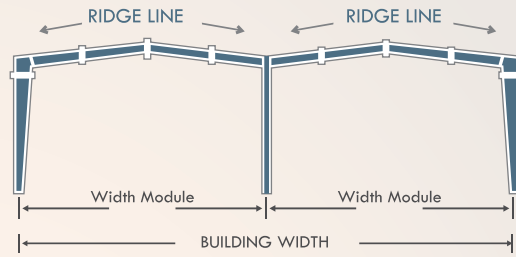

### Multi Span I

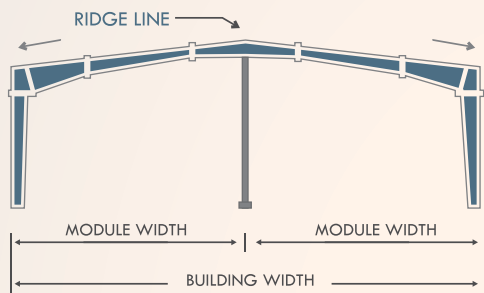

### Clear Span with Crane

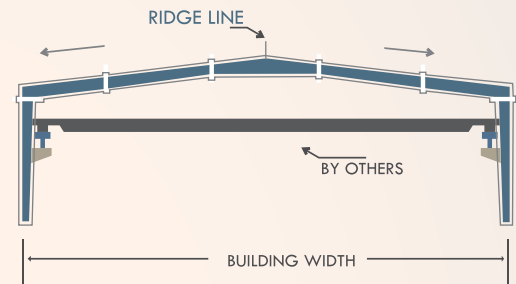

### Multi Span II

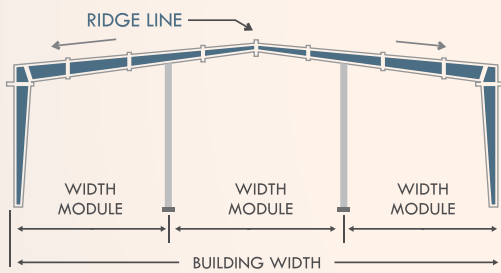

### Mono Slope

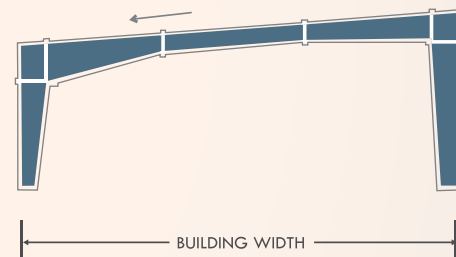

### Multi Span III

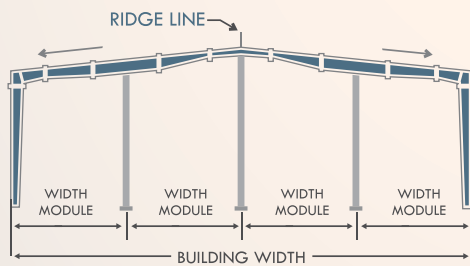

### Rafter System

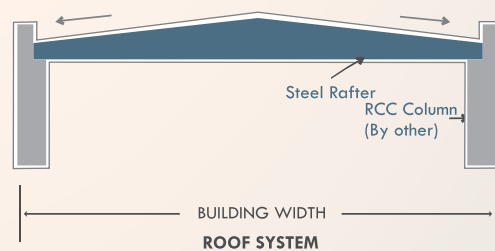

### Lean - To

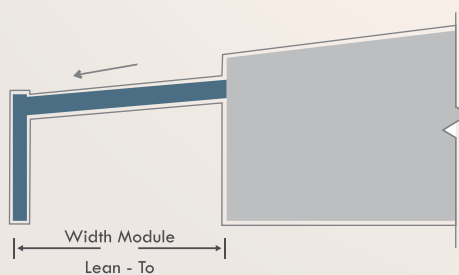

### Multi Span I with Crane & Mezzanine

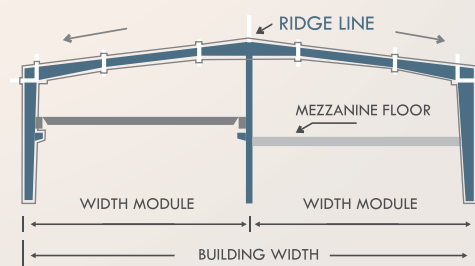





CNC Plasma Machine



H-Beam Auto Welding Machine



Multi Torch Cutting Machine

## Key Machinery

Sheeting Machine



CZ Purlin Machine



CNC Drilling Machine





## Application Codes

Welding is designed in accordance with : Structure Welding Code-Steel Manual 2008 AWS D.1.1:2008

Wind Speed is applied in accordance with : IS 875 (Part3) : 2015 Code for Practice for Design.

Cold Formed members are designed in accordance with : 1996 Edition of Cold Formed Steel Design Manual, American Iron & Steel Institute (AISI).

Hot rolled Section & Built up Sections are Designed in accordance with : 1989 Manual of steel construction, Allowable stress Design, American Iron & steel Institute const (AISC).

Design for seismic loads, collateral loads or any other local conditions must be specified at that time of enquiry.

Loads are applied in accordance with the latest American codes & standards applicable to pre-engineered buildings unless otherwise requested at the time of Enquiry

## Design load considerations :-

Dead Load	:	0.11 KN/M <sup>2</sup>
Live Load	:	0.50-0.75 KN/M <sup>2</sup>
Wind Load	:	As per IS 875:2015 (Part) 3 for location, for Aurangabad 39M/Sec.
Roof Slope	:	1 : 10
Bay Spacing	:	6M & 7.5M are most common.
Eaves Height	:	4.00 Mt. To 12.00 Mt. from FFL Level to Top of Eaves Strut.

### Material specification for various components :-

No	Components	Specifications	Minimum Yield Strength
1	<b>Primary Members</b> Built up Frames/Portal Frames	ASTMA- 572 Grade 50 (or Equivalent)	YS = 345 MPa
2	<b>Secondary Members</b> <b>Cold Formed</b> HR Steel, Galvanized Steel	ASTMA- 570 or IS 1079/10748 ASTMA- 653 MSS Gr. 34 Mpa (Coating 120 GSM)	YS = 245 MPa YS = 345 MPa
3	<b>Roof/Wall Sheeting &amp; Panels</b> Bare & Colour Coated	ASTMA- 792 Grade DAZ 150	YS = 345 or 550 MPa
4	<b>Mezzanine Deck Panels</b> Galvanized Sheet	ASTMA- 653 SS Gr. 55, (Zinc Coating 120 GSM)	YS = 550 MPa
5	<b>Roof/Wall Bracings</b> Rod round bar	ASTMA- 36M / IS 2062 (or Equivalent)	YS = 245 MPa
6	<b>Anchor Bolts</b>	ASTMA- 36M / IS 2062 (or Equivalent)	YS = 245 MPa
7	<b>Galvanized M S Bolts</b>	ASTMA- 307 / IS 1367 (or Equivalent) Grade 4.6 hot dip Galvanized / plating yellow colour	YS = 245 MPa
8	<b>High Strength Bolts</b> For Rafter	ASTMA- 325 Type Gr. 8.8 (or Equivalent)	UTS 830 MPa
9	<b>Valley Gutter</b>	IS 513 Grade O or D	YS = 240 MPa

## Typical pre-engineered steel buildings

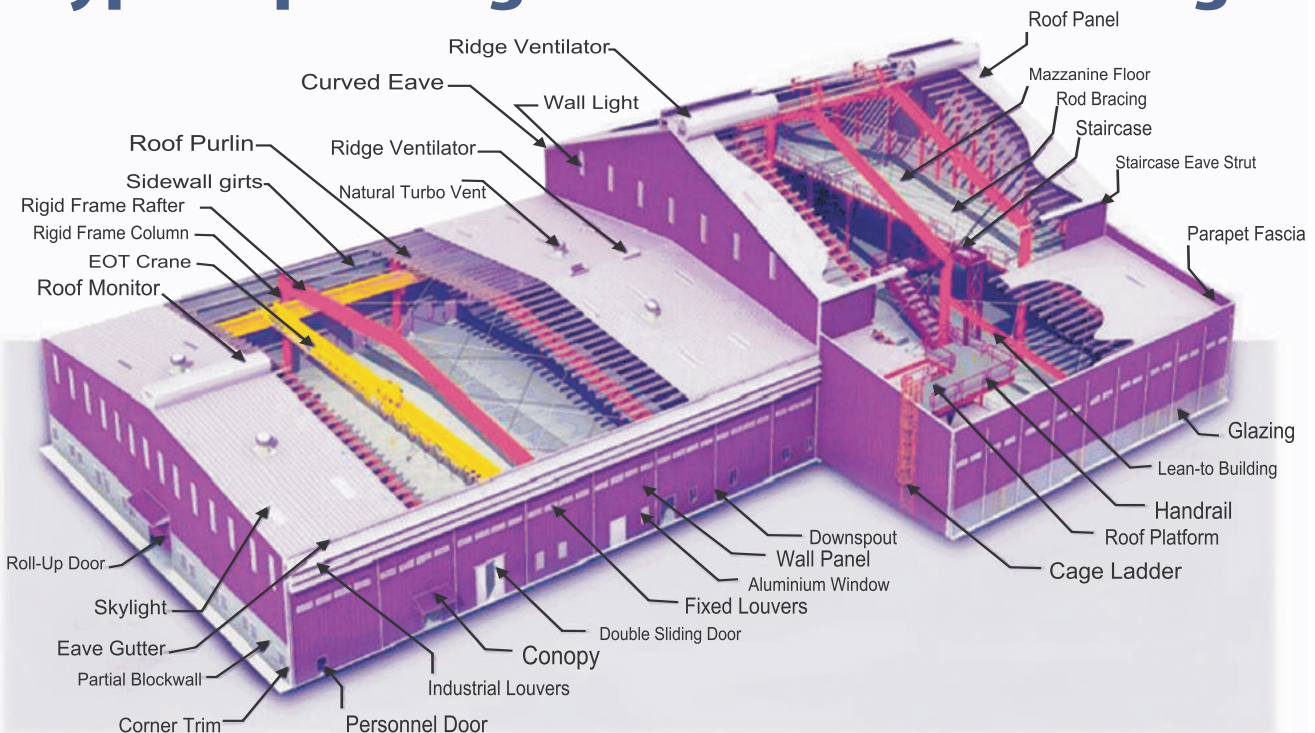

# Accessories

Roof Monitor | Ridge Vents | Turbo Vents | Skylights | S-Type Louvers | Gutter | Downtake

## Ridgevent System

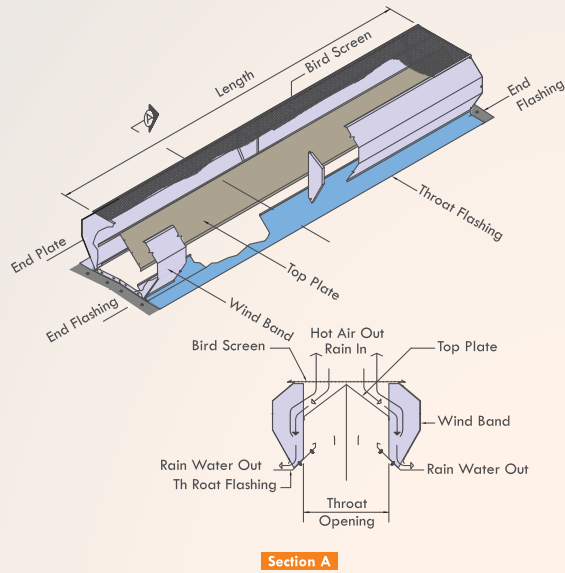

## S-type Louver Detail

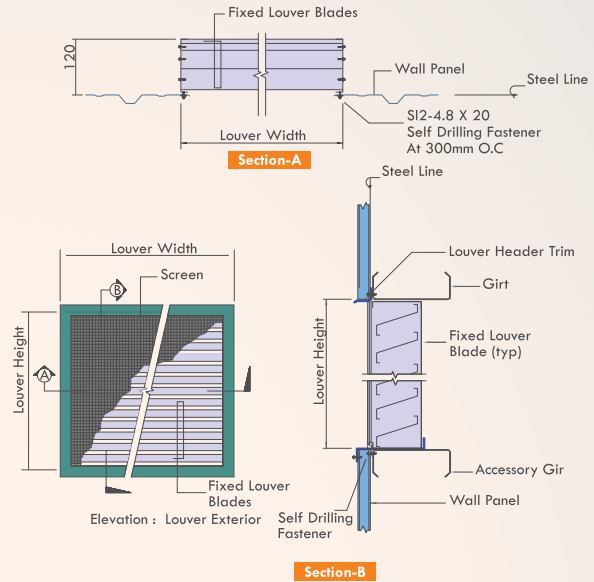

## Roof Monitor

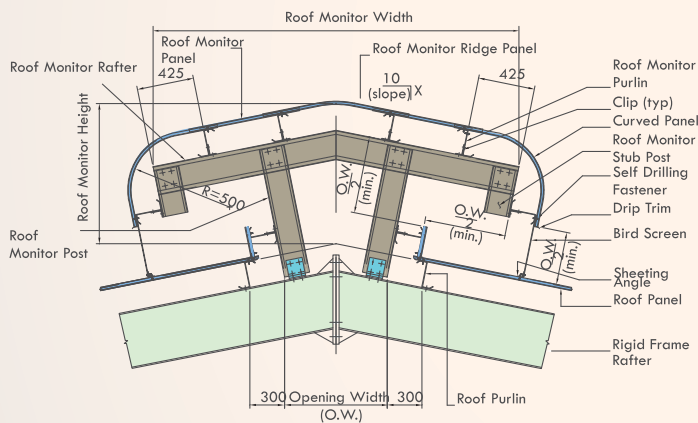

## Turbovent Fixing Detail

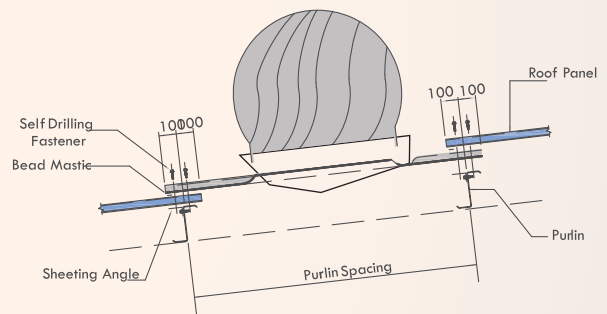

## Gutter / Downtake Fixing To Wallpanel Using Strap

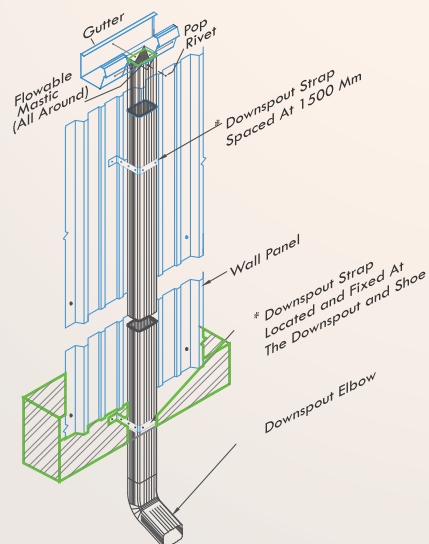

## Sky Lights And Wall Lights

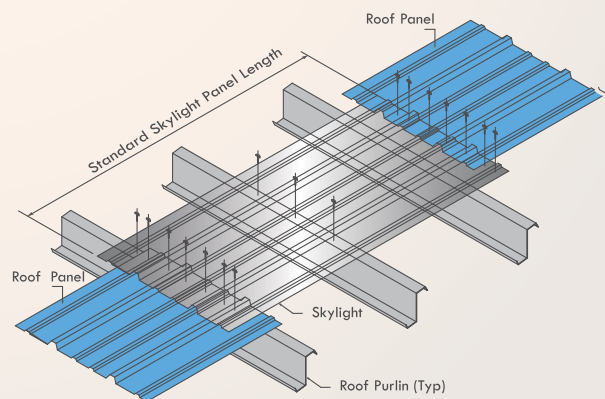





+91 70455 21507, +91 86000 25140

swastikmetcon@gmail.com

<http://www.swastikmetcon.com/>

A 130, Shendra Commercial Complex,  
Shendra MIDC, Aurangabad - 431 201